

KCM Ultra Chains (Oilless type)

NL Type

● Order Product Code
KCM40NL-240 Links
10ft

Chain No. Unit

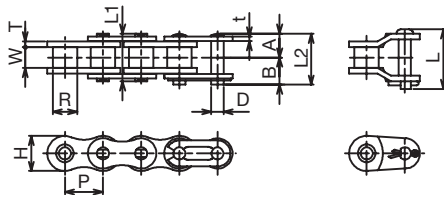

Chain No.	Pitch P	Roller Outer Diameter R	Inner Link Inner Width W	Link Plate			Pin					Average Tensile Strength kN (kgf)	Maximum Allowable Tension kN (kgf)	
				Thickness T	t	Width H	Diameter D	A	B	L	L1			L2
KCM 40NL	12.70	7.92	7.95	2.0	1.5	11.7	3.97	8.6	10.10	21.00	17.2	18.70	18.1(1,850)	3.63(370)
KCM 50NL	15.875	10.16	9.53	2.4	2.0	14.6	5.09	10.6	12.05	24.65	21.2	22.65	29.9(3,050)	6.37(650)
KCM 60NL	19.05	11.91	12.70	3.2	2.4	17.5	5.96	13.5	15.10	32.65	27.0	28.60	41.2(4,200)	8.83(900)
KCM 80NL	25.40	15.88	15.88	4.0	3.2	23.0	7.94	16.9	20.00	40.15	33.8	36.90	72.6(7,400)	14.7 (1,500)

Chain No.	Product Code	Approx. Weight kg/m	No. of Links	Standard Issue	No. in Box (Units or Items)
KCM 40NL	40NL-T	0.67	240L	3m	10
	40NL-JL				100
	40NL-OL				
KCM 50NL	50NL-T	1.08	192L	3m	5
	50NL-JL				50
	50NL-OL				
KCM 60NL	60NL-T	1.63	160L	3m	5
	60NL-JL				25
	60NL-OL				
KCM 80NL	80NL-T	2.76	120L	3m	3
	80NL-JL				20
	80NL-OL				

* Operating temperature: -10 to 150°C

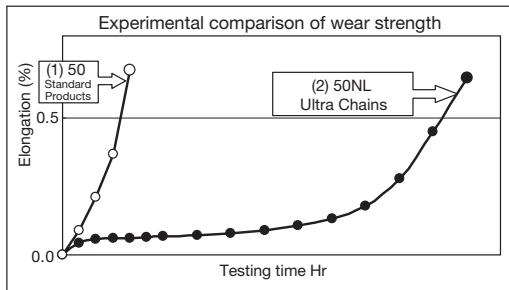
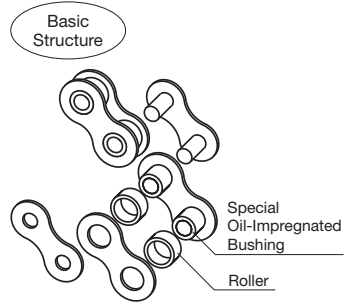

Features KANA Ultra (oilless type) Chains are maintenance-free chains using special oil-impregnated bushings for self-lubrication. Use them for places where lubrication is hard to implement or should be avoided. Black oxide finish is implemented on the plate to improve corrosion resistance. In addition, a nickel plating type is also available.



* Because the inside plate is designed to be thick, pins are longer than those of standard chains.
 * Although standard sprockets can be used for single rows, dedicated sprockets are required for multiple rows. Coupler links of 80NL are cotter pin type.