

Roller chains with high precision machined attachments. Ideal for high accuracy transportation as a small conveyor type due to the fine pitch.

SA-1 Attachment

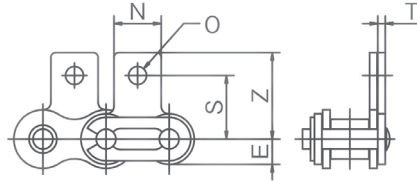

SK-1 Attachment

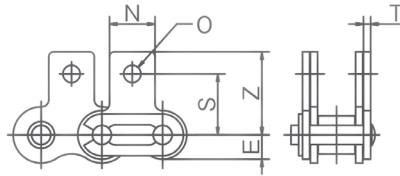

(Units: mm)

Chain No.	Pitch P	Inner Link Inner Width W	Roller Outer Diameter D	Standard / Rustop (N)			Stainless Steel (SS)		No. of Links for 1 Unit
				Average Tensile Strength kN (kgf)	Maximum Allowable Tension kN (kgf)	Approx. Mass (kg/m)	Maximum Allowable Tension kN (kgf)	Approx. Mass (kg/m)	
KCM 25	6.35	3.18	*3.30	4.1(425)	0.64(65)	0.15	0.12(12)	0.16	480
KCM 35	9.525	4.78	*5.08	10.2(1,040)	1.57(160)	0.33	0.26(27)	0.33	320
KCM 40	12.70	7.95	7.92	17.2(1,750)	2.75(280)	0.61	0.44(45)	0.63	240
KCM 50	15.875	9.53	10.16	27.9(2,850)	4.41(450)	1.01	0.69(70)	1.04	192
KCM 60	19.05	12.70	11.91	39.5(4,000)	6.28(640)	1.49	1.03(105)	1.50	160
KCM 80	25.40	15.88	15.88	68.6(7,000)	10.69(1,090)	2.50	1.77(180)	2.62	120
KCM 100	31.75	19.05	19.05	106.9(10,900)	17.06(1,740)	3.85	2.55(260)	4.09	96
KCM 120	38.10	25.40	22.23	149.1(15,200)	23.93(2,440)	5.66	-	-	80

Coupler links of 80 or more are cotter pin type. * The mark indicates bushings diameter.

(Units: mm)

Chain No.	Attachment									Applied Load per Attachment (kg)	
	N	O	E	C	X	Y	S	Z	A,SA-1	K,SK-1	
KCM 25	5.6	3.4	2.9	4.75	7.15	10.7	7.95	11.9	0.0003	0.0006	
KCM 35	7.9	3.4	4.4	6.35	9.5	13.8	9.5	14.25	0.0009	0.0018	
KCM 40	9.5	3.6	5.8	7.9	12.7	17.4	12.7	17.3	0.0014	0.0028	
KCM 50	12.7	5.2	7.3	10.3	15.9	22.3	15.9	22.3	0.0032	0.0062	
KCM 60	15.9	5.2	8.8	11.9	19.05	27.2	18.3	26.3	0.0056	0.012	
KCM 80	19.1	6.8	11.5	15.9	25.4	35.2	24.6	34.2	0.013	0.026	
KCM 100	25.4	8.7	14.4	19.8	31.75	44.7	31.8	44.1	0.025	0.050	
KCM 120	28.6	10.3	17.5	23.0	38.1	52.5	36.55	50.9	0.038	0.076	

Stainless steel types have the same dimensions.