

KCM Stainless Steel Double Pitch Roller Chains with Attachments

Stainless Steel
K1/K2-type Attachments

● **Order Product Code**
KCMC2040- SUS 2L K1 120 Links
10ft

Chain No. Material Configuration Type Unit

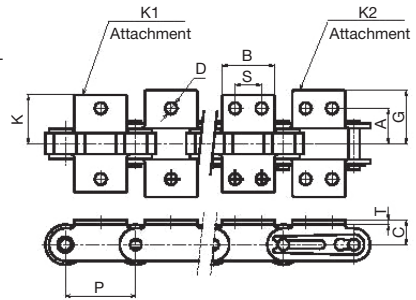
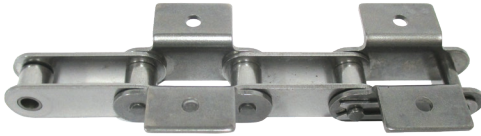

Figure: ALL K1/K2

Double pitch roller chains stainless steel specification.
 The S-type and R-type are available for rollers. The K1/K2 types are available for chains with attachments.

Chain No.		Attachment		Pitch P	Common Dimensions				Attachment K1/K2			
Type	Roller Shape	Configuration	Type		C	B	D	T	A	K	G	S
KCM C2040 KCM C2042	S R	ALL 2L	K1 K2	25.40	9.1	19.1	3.6	1.5	12.7	17.4	19.0	9.5
KCM C2050 KCM C2052	S R			31.75	11.1	23.8	5.2	2.0	15.9	21.9	24.0	11.9
KCM C2060H KCM C2062H	S R			38.10	14.7	28.6	5.2	3.2	21.45	28.4	31.8	14.30
KCM C2080H KCM C2082H	S R			50.80	19.1	38.1	6.8	4.0	27.8	37.0	41.1	19.10

Chain No.		Maximum Allowable Tension kN (kgf)	Attachment Attached per Location Approx. Weight g	Approx. Weight kg/m	Unit	
Type	Roller Shape				No. of Links	m
KCM C2040 KCM C2042	S R	0.44 (45)	6	0.49 0.83	120L	3
KCM C2050 KCM C2052	S R	0.69 (70)	14	0.83 1.28	96L	
KCM C2060H KCM C2062H	S R	1.03 (105)	32	1.46 2.14	80L	
KCM C2080H KCM C2082H	S R	1.77 (180)	66	2.44 3.50	60L	

* There are no OL for chains with stainless steel attachments.
 Caution