

NEW

KANA Bearings

**Order No. Example****KB 6000ZZ**

Type

No.

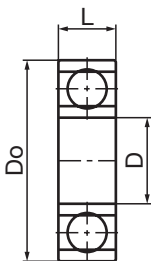

The bearing inserted into the KANA standard idler sprocket is a dedicated bearing inscribed with the "KANA" brand on its seal. This bearing is highly compatible with idler sprockets, and features smooth and quiet rotation. When replacing bearings, we recommend KANA standard idler sprocket dedicated bearings.

m High-carbon Bearing Steel

Type	No.	Inner Diameter D	Outer Diameter Do	Total Width L	Applicable Idler Sprockets				Weight g	¥
KB	6000ZZ	10	26	8	ID35C16D10	WID35B16D10	WID35C16D10	-	19	
					ID40C13D10	WID40B13D10	WID40C13D10			
	6001ZZ	12	28	8	ID35C16D12	WID35B16D12	WID35C16D12	-	22	
					ID40C13D12	WID40B13D12	WID40C13D12			
	6201ZZ	12	32	10	ID50C12D12	WID50B12D12	WID50C12D12	-	37	
					ID60C11D12	WID60B11D12	WID60C11D12			
	6202ZZ	15	35	11	ID35C18D15	WID35B18D15	WID35C18D15	EPID35C18D15	45	
					ID40C15D15	WID40B15D15	WID40C15D15	EPID40C15D15		
					ID50C13D15	WID50B13D15	WID50C13D15	EPID50C13D15		
					ID60C11D15	WID60B11D15	WID60C11D15	EPID60C11D15		
	6203ZZ	17	40	12	ID35C21D17	WID35B21D17	WID35C21D17	-	66	
					ID40C17D17	WID40B17D17	WID40C17D17			
					ID50C15D17	WID50B15D17	WID50C15D17			
					ID60C13D17	WID60B13D17	WID60C13D17			
	6204ZZ	20	47	14	ID35C25D20	WID35B25D20	WID35C25D20	-	106	
					ID40C19D20	WID40B19D20	WID40C19D20			
					ID50C17D20	WID50B17D20	WID50C17D20			
					ID60C14D20	WID60B14D20	WID60C14D20			
						ID80C11D20	WID80B11D20	WID80C11D20		



Order Method

KANA Bearing Type [No.] and Quantity



Guide

* Use as a repair part for the KANA standard idler sprocket.

▶▶ P104
P106 and
P107

Iron



Postage

Same-day shipping

* Also, use the KANA standard snap ring at the same time.

▶▶ Page 111



Iron



Precautions

* The radial internal clearance is C3.

NEW

SUS KANA Bearings

● **Order No. Example**
SUSKB 6000ZZ
 Type No.

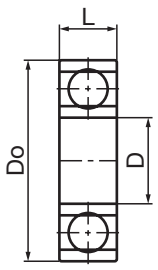
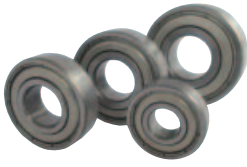

The bearing inserted into the KANA standard idler sprocket is a dedicated bearing inscribed with the "KANA" brand on its seal.

This bearing is highly compatible with idler sprockets, and features smooth and quiet rotation. When replacing bearings, we recommend KANA standard idler sprocket dedicated bearings.

 Martensitic Stainless Steel

Type	No.	Inner Diameter D	Outer Diameter Do	Total Width L	Applicable Idler Sprockets					Weight g	¥
SUSKB	6000ZZ	10	26	8	SUSID35C16D10	SUSID40C13D10	-	-		19	
	6001ZZ	12	28	8	SUSID35C16D12	SUSID40C13D12	-	-		22	
	6201ZZ	12	32	10	SUSID50C12D12	SUSID60C11D12	-	-		37	
	6202ZZ	15	35	11	SUSID35C18D15	SUSID40C15D15	SUSID50C13D15	SUSID60C11D15	SUSID80C9D15	45	
	6203ZZ	17	40	12	SUSID35C21D17	SUSID40C17D17	SUSID50C15D17	SUSID60C13D17	SUSID80C10D17	66	
	6204ZZ	20	47	14	SUSID35C25D20	SUSID40C19D20	SUSID50C17D20	SUSID60C14D20	SUSID80C11D20	106	



KANA Bearing Type No. and Quantity



* Use as a repair part for the KANA standard idler sprocket.

▶▶ P105



Stainless Steel



Same-day shipping

Postage

* Also, use the KANA standard snap ring at the same time.

▶▶ P113



Stainless Steel



* The radial internal clearance is C3.

Precautions