

Comeback Products

KanaLocks

KL201-type (Flange, Small Outer Diameter Type)

● Order No. Example

KL201 8×21

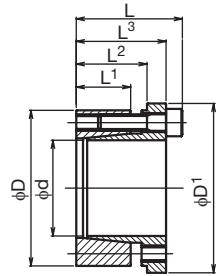
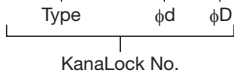

The KL201-type, in addition to the features offered by the conventional KL201FH-type, allows a more compact design because the ratio of inner/outer diameter has been made smaller. Additionally, since a slit has been put in at a single location for each of the inner ring/outer ring, it can handle a broad range of axis tolerances. Boss hole (m6, k6, j6, h6 to h8) and shaft fit is up to H8.

 Special Structural Steel

Type	φd	φD	L	L3	L2	L1	D1	Clamp Screw		Maximum Allowable Torque N·m	Bolt Tightening Torque N/m	Weight g	¥
								No. of Units	Size				
KL 201	8	21	21	17	14.5	10	23.5	3	M4×15	21	4	35	
	10	23					25.5			27		40	
	11	24					26.5			39		45	
	12	26					28.5			43		53	
	14	28	23	19	16.5	12	30.5	6	M4×15	76	4	61	
	15	29					31.5			81		66	
	16	30					32.5			86		75	
	17	31					33.5			120		75	
	18	32					34.5			130		80	
	19	33					35.5			130		81	
	20	38	31	26	21.5	16	42	8	M5×20	220	8	144	
	22	40					44			250		165	
	24	42					46			270		180	
	25	43					47			280		188	
	28	46	34	29	23.5	18	50	10	M5×20	400	8	195	
	30	48					52			420		208	
	32	50					54			450		219	
	35	57	39	33	26	20	62	8	M6×25	660	16	325	
	38	60					65			900		362	
	40	62					67			950		380	
42	64	39	33	26	20	69	10	M6×25	1,000	16	405		
45	67					72			1,070		435		
48	70					75			1,370		460		
50	72					77			1,660		485		



KanaLock No. and quantity



3-day shipping

* Single order system available



* Concerning the measurements and options not listed here, please contact our sales office.