

Comeback Products

KanaLocks

KL300-type

● Order No. Example

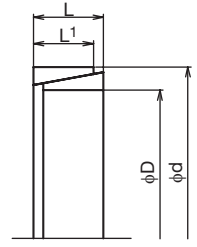
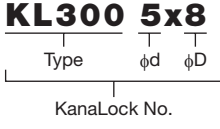

As the KL300-type is completely set up in a mounting space which is extremely small in the radial direction, it is possible to select up to 4 built-in KanaLocks. This also allows a large torque to be transmitted. Connection is made through a KL300S pressure flange. Boss hole and shaft fit is up to H8/h8.

 Special Structural Steel

Type	φd	φD	L	L1	Maximum Allowable Torque N·m	Weight g	¥
KL300	5	8	4.5	3.7	1.7	0.9	
	6	9			2.5	1.1	
	6.35	9.5			3.0	1.2	
	7	10			3.4	1.4	
	8	11			4.4	1.5	
	9	12	4.5	3.7	5.5	1.7	
	9.5	12.5			6.2	1.8	
	11	14			8.4	2.0	

Please refer to the KPL300-type on the next page for the intermediate dimensions.

KL300	φd	φD	L	L1	Maximum Allowable Torque N·m	Weight g	¥
KL300	85	96	17	15	2,100	190	
	90	101			2,350	200	
	95	106			2,620	210	
	100	114	21	18.7	3,620	360	
	110	124			4,380	380	
	120	134			5,210	420	
	130	148	28	25.3	8,390	800	
	140	158			9,730	860	
	150	168	28	25.3	11,150	920	
	160	178			12,700	960	
	170	191	33	30	17,100	1,450	
	180	201			19,200	1,500	
	190	211			21,300	1,600	
	200	224	38	34.8	27,400	2,200	



KanaLock No. and quantity



3-day shipping
* Single order system available



* Please contact our sales office about the selection.
* We offer cost-performance products for dimensions which are not listed. Please refer to P339.