

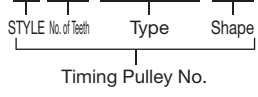

XL037-type

K-Timing Pulley <Prepared Hole Product>

Order No. Example

K 20 XL037 BF

(Type)
XL037
W: 11
H: 2.0

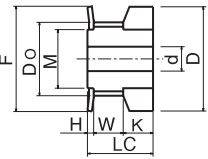
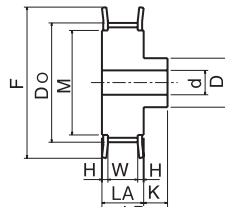
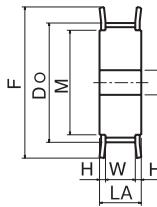
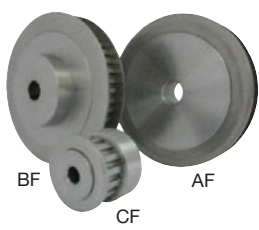

The KANA Timing Pulley achieves clean transmission thanks to its low noise that comes by way of its excellent timing transmission performance.

Type	No. of Teeth	Shape	Dp	Do	LA	LB	LC	K	D	d		F	M	Compatible Flanges	Pulley Approx. Weight kg	
										min	max					
XL037	10	CF	16.17	15.66	-	-	23	10	23	4	8	23	12	KTF-102312	0.041	
	11	CF	17.79	17.28	-	-	23	10	25	5	9	25	13	KTF-102513	0.048	
	12	CF	19.40	18.90	-	-	23	10	25	6	10	25	14	KTF-102514	0.051	
	14	CF	22.64	22.13	-	-	23	10	28	6	14	28	18	KTF-102818	0.068	
	15	CF	24.25	23.75	-	-	23	10	28	6	14	28	18	KTF-102818	0.072	
	16	BF	25.87	25.36	15	23	-	8	17	6	10	31	20	KTF-103120	0.055	
	18	BF	29.11	28.60	15	23	-	8	19	6	12	33	22	KTF-103322	0.071	
	19	BF	30.72	30.22	15	23	-	8	19	6	12	35	22	KTF-103522	0.078	
	20	BF	32.34	31.83	15	23	-	8	22	8	14	38	26	KTF-103826	0.088	
	21	BF	33.96	33.45	15	23	-	8	22	8	14	38	26	KTF-103826	0.096	
	22	BF	35.57	35.07	15	23	-	8	24	8	16	43	28	KTF-104328	0.108	
	24	BF	38.81	38.30	15	23	-	8	27	8	18	44	32	KTF-104432	0.132	
	25	BF	40.43	39.92	15	23	-	8	28	8	19	44	32	KTF-104432	0.144	
	26	BF	42.04	41.53	15	23	-	8	29	8	20	47	34	KTF-104734	0.157	
	28	BF	45.28	44.77	15	23	-	8	30	8	21	48	36	KTF-104836	0.180	
	30	BF	48.51	48.00	15	23	-	8	33	10	24	55	39	KTF-105539	0.208	
	32	AF, BF	51.74	51.24	15	25	-	10	38	10	26	57	41	KTF-105741	0.216	0.304
	34	AF, BF	54.98	54.47	15	25	-	10	38	10	26	61	41	KTF-106141	0.246	0.335
	36	AF, BF	58.21	57.70	15	25	-	10	38	10	26	61	41	KTF-106141	0.279	0.367
	38	AF, BF	61.45	60.94	15	25	-	10	38	10	26	65	50	KTF-106550	0.313	0.402
40	AF, BF	64.68	64.17	15	25	-	10	38	10	26	69	50	KTF-106950	0.350	0.438	
42	AF, BF	67.91	67.41	15	25	-	10	38	10	26	74	53	KTF-107453	0.388	0.476	
44	AF, BF	71.15	70.64	15	25	-	10	38	10	26	78	58	KTF-107858	0.428	0.517	
46	AF, BF	74.38	73.87	15	25	-	10	38	10	26	83	63	KTF-168363	0.467	0.555	



Timing Pulley No. and Quantity



Guide

* Since we also manufacture sizes other than those in the catalog, and machine shaft holes/keys/taps, etc., depending on your request, please contact our company's sales office for details.



Same-day shipping



Precautions

* The prepared hole diameter is finished at the minimum diameter H7. Comes with a flange.

XL037-type

K-Timing Pulley <Prepared Hole Product>



* Please use with timing belt. ▶▶ P.440 -

* While flanges are included, for additional flanges, consult here. ▶▶ P.434 -



Product Name	Material
Pulley	Carbon Steel
Flange	Common Steel

* XL037 (for 9.5mm)

Type	No. of Teeth	AF		BF		CF	
		¥	Semi-F ¥	¥	Semi-F ¥	¥	Semi-F ¥
XL 037	10						
	11						
	12						
	14						
	15						
	16						
	18						
	19						
	20						
	21						
	22						
	24						
	25						
	26						
	28						
	30						
	32						
	34						
36							
38							
40							
42							
44							
46							

* Please refer to P24 to P33 for the Semi-F Series <Complete Product> order method.