

# K-Timing Pulley Flange

Flange for MXL/XL/L/S2M/S3M/S5M/T5/T10  
(Stainless Steel/Thickness 1.0-type)

● Order No. Example

**KTS103826**

Flange No.

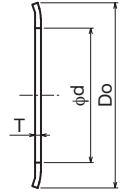
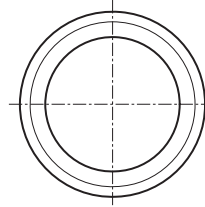

 SUS304

Flange No.	Outer Diameter Do	φd	T	Pulley No. and No. of Teeth							¥			
				MXL	XL	L	S2M	S3M	S5M	T5		T10		
KTS-101306	13	6	1.0				14,15							
KTS-101508	15	8					16,18							
KTS-101610	16	10					20	14						
KTS-101811	18	11		20,21,22				22	15					
KTS-102012	20	12		23,24				24	16					
KTS-102312	23	12		25,26		10		26	18		11,12			
KTS-102313	23	13		27,28,29,30				28,30	20					
KTS-102513	25	13				11								
KTS-102514	25	14		31		12,13		32	22		13			
KTS-102616	26	16		32,33,34,35				34,36	24	14	14			
KTS-102818	28	18		36,37,38,39		14,15			26	15	15,16			
KTS-103120	31	20		40,41,42		16		40	28	16	17,18			
KTS-103322	33	22		43,44,45,46		17,18		44	30	18	19			
KTS-103522	35	22		47,48,49,50		19	10	48,50	32	20	20		10	
KTS-103826	38	26		51,52,53,54		20,21	11		34		21		11	
KTS-104028	40	28		55,56,57,58					36	22	22,23			
KTS-104328	43	28				22,23	12				24,25		12	
KTS-104432	44	32		59,60,61,62,63		24,25	13	60	40	24			13	
KTS-104734	47	34		64,65,66,67		26	14		44	26	26,27		14	
KTS-104836	48	36		68,69,70		27,28			48	28	28			
KTS-105136	51	36	71,72,73,74,75		29			50		29,30				
KTS-105441	54	41	76,77,78,79							31,32				
KTS-105539	55	39			30									
KTS-105741	57	41	80,81,82,83		31,32,33					33				
KTS-106141	61	41	84,85,86,87,88,89,90		34,35,36			60		34,35,36				
KTS-106550	65	50	91,92,93,94,95		37,38					37,38				
KTS-106950	69	50	96,97,98,99,100,101,102		39,40					39,40,41				
KTS-107453	74	53	103,104,105,106,107,108,109,110		41,42,43					42,43,44				
KTS-107858	78	58	111,112,113,114,115		44,45					45,46,47				
KTS-108363	83	63												
KTS-108666	86	66												



Order Method

Flange No. and Quantity



Precautions

\* For the Timing Belt transmission, the belt is offset in one direction or the other during rotation. A Pulley Flange installation is recommended during the design phase.

\* 2 per set



Postage

Same-day shipping

# K-Timing Pulley Flange

Flange for MXL/XL/L/H/S5M/T5/T10 (Stainless Steel/Thickness 1.6-type)

m: SUS304

Flange No.	Outer Diameter Do	φd	T	Pulley No. and No. of Teeth							¥
				MXL	XL	L	H	S5M	T5	T10	
KTS-165136	51	36	1.6			15		30		15	
KTS-165441	54	41				16		32			
KTS-165539	55	39				17				16	
KTS-165741	57	41				18	14	34,36		17,18	
KTS-166141	61	41									
KTS-166550	65	50				19,20	15			19	
KTS-166950	69	50				21	16	40		20	
KTS-167453	74	53				22,23	17	44		21,22	
KTS-167858	78	58				24	18			23	
KTS-168363	83	63			116,117,118	46,47	25	19	48	48,49,50	24
KTS-168666	86	66			119,120	48,49,50	26,27	20	50	51,52	25,26
KTS-169073	90	73				51,52	21			53,54	27
KTS-169375	93	75				53,54,55	28,29	22		55,56	28
KTS-169978	99	78				56,57,58,59	30,31	23	60	57,58,59,60	29,30
KTS-1610584	105	84				60,61,62,63	32	24		61,62,63	31,32
KTS-1610884	108	84					33	25		64,65	
KTS-1611290	112	90				64,65	34,35	26		66,67	33,34
KTS-1611590	115	90				66,67,68	36	27		68,69,70	35
KTS-1611890	118	90				69,70,71	37	28		71,72	36
KTS-16126100	126	100				72,73,74,75	38,39,40	29,30		73,74,75,76,77	37,38
KTS-16131101	131	101				42					
KTS-16136118	136	118			80	43	32		81,82,83	41	
KTS-16138125	138	125			81,82,83	44	33		84,85	42	
KTS-16146128	146	128			84,85,86,87	45,46	34,35		86,87,88,89	43,44	
KTS-16152134	152	134			88,89,90,91	47,48	36		90,91,92	45,46	
KTS-16159141	159	141				49,50	38			47,48	
KTS-16168150	168	150					40				