

# ◇ Sprocket for use with Triple Speed/Carrier Chain



## ● Order No. Example

**C5B10N**

Sprocket No.

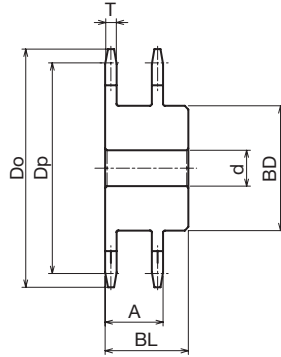

**m** Carbon Structural Steel

Sprocket No.	No. of Teeth	Pitch Diameter Dp	Outer Diameter Do	Tooth Width T	Shaft Hole Diameter d			Boss		A	¥	Semi-F ¥
					Prepared hole	Minimum	Maximum	BD	BL			
C3B9N	9	55.70	63	3	10	11	21	33	22	15.3		
C3B10N	10	61.65	68	3	13	14	23	37	25	15.3		
C4B10N	10	82.20	93	4	16	17	33	52	40	21.5		
C4B11	11	90.16	102	4	16	17	36	58	35	21.5		
C4B12	12	98.14	110	4	16	17	41	65	35	21.5		
C5B10N	10	102.75	117	5	16	17	41	66	45	27		
C5B11	11	112.70	127	5	20	21	48	77	50	27		
C5B12N	12	122.67	138	5	20	21	54	87	45	27		
C6B10N	10	123.30	137	6	19	20	51	81	50	31		
C6B11	11	135.24	150	6	20	21	50	80	50	31		
C6B12	12	147.21	162	6	20	21	50	80	50	31		



Order Method

Sprocket No.  and Quantity



Postage

Same-day shipping

\* Please refer to P24 to P33 for the Semi-F Series <Complete Product> order method.

Semi-F Series  
of FITLINK  
Roller  
Chains  
Chain  
Accessories  
Idlers &  
Tensioners  
Sprockets  
Oiless  
Bushings  
Transmission  
Accessories  
Conveyor Chains/  
Spindles  
Chain  
Couplings  
Roller  
Chains  
Triple Speed/Carrier  
Pulleys/Drums  
Timing Belts/  
Pulleys/Flanges  
Shaft Collars  
Pinions/Racks/  
Miter Gears  
Imperfect  
Products